



36 Filton Avenue

Horfield, Bristol, BS7 0AG

£5,250 Per month



** 7-Bedroom Student House - Academic Year 2026 - Prime Location **

Ideal for students seeking a spacious and comfortable living environment for the upcoming academic year, this impressive 7-bedroom end-of-terrace house is located at beginning of the Filton Avenue in the vibrant area of Horfield.

The property boasts a large dining room and a cozy sitting area, perfect for socialising and studying with friends. Two Bathrooms and seven double size bedrooms with all furnitures included.

This property is ideally located close to Gloucester Road with all shops, bars, takeaways, and local amenities just a walking distance away.

It is also within easy reach of the University of the West of England (UWE), with a nearby bus stop providing convenient transport options.



- Lounge
- Kitchen
- Room 1
- Room 2
- Room 3
- Room 4
- Room 5
- Room 6
- Room 7
- Bathroom
- Garden
- Utility
- WC

Area Map

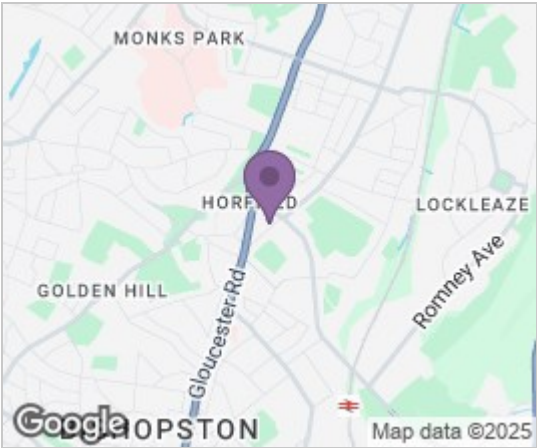

Floor Plans

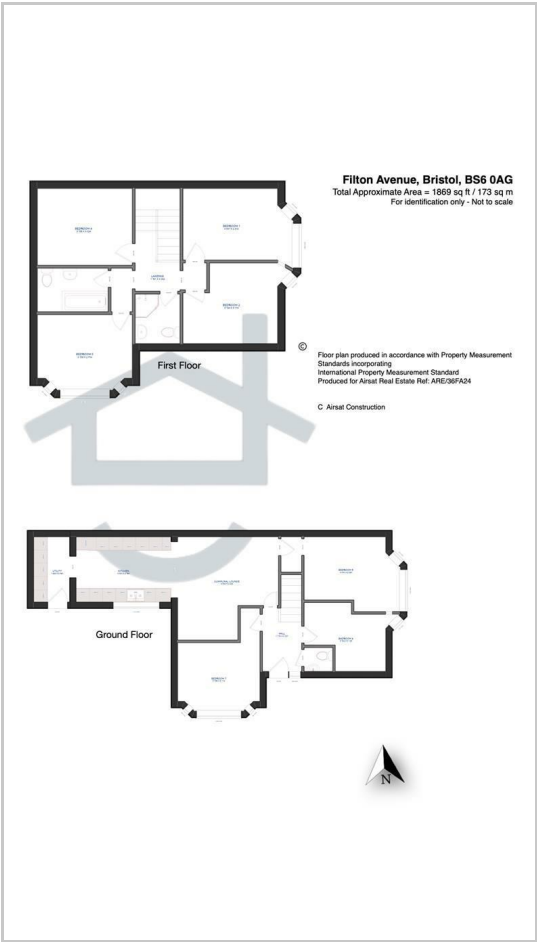

Energy Efficiency Graph

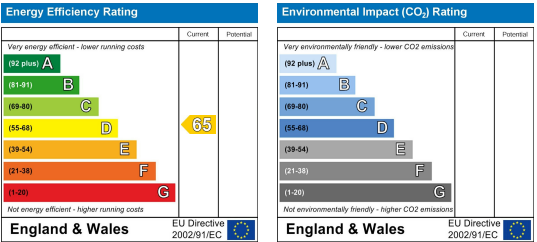

These particulars, whilst believed to be accurate are set out as a general outline only for guidance and do not constitute any part of an offer or contract. Intending purchasers should not rely on them as statements of representation of fact, but must satisfy themselves by inspection or otherwise as to their accuracy. No person in this firms employment has the authority to make or give any representation or warranty in respect of the property.

